

THIS DRAWING IS THE COPYRIGHT OF NT architect AND MAY NOT BE REPRODUCED, COPIED OR REPRODUCED WITHOUT WRITTEN PERMISSION. NO LIABILITY WILL BE ACCEPTED FOR AMENDMENTS MADE BY OTHER PERSONS. DO NOT SCALE OFF THE DRAWINGS.

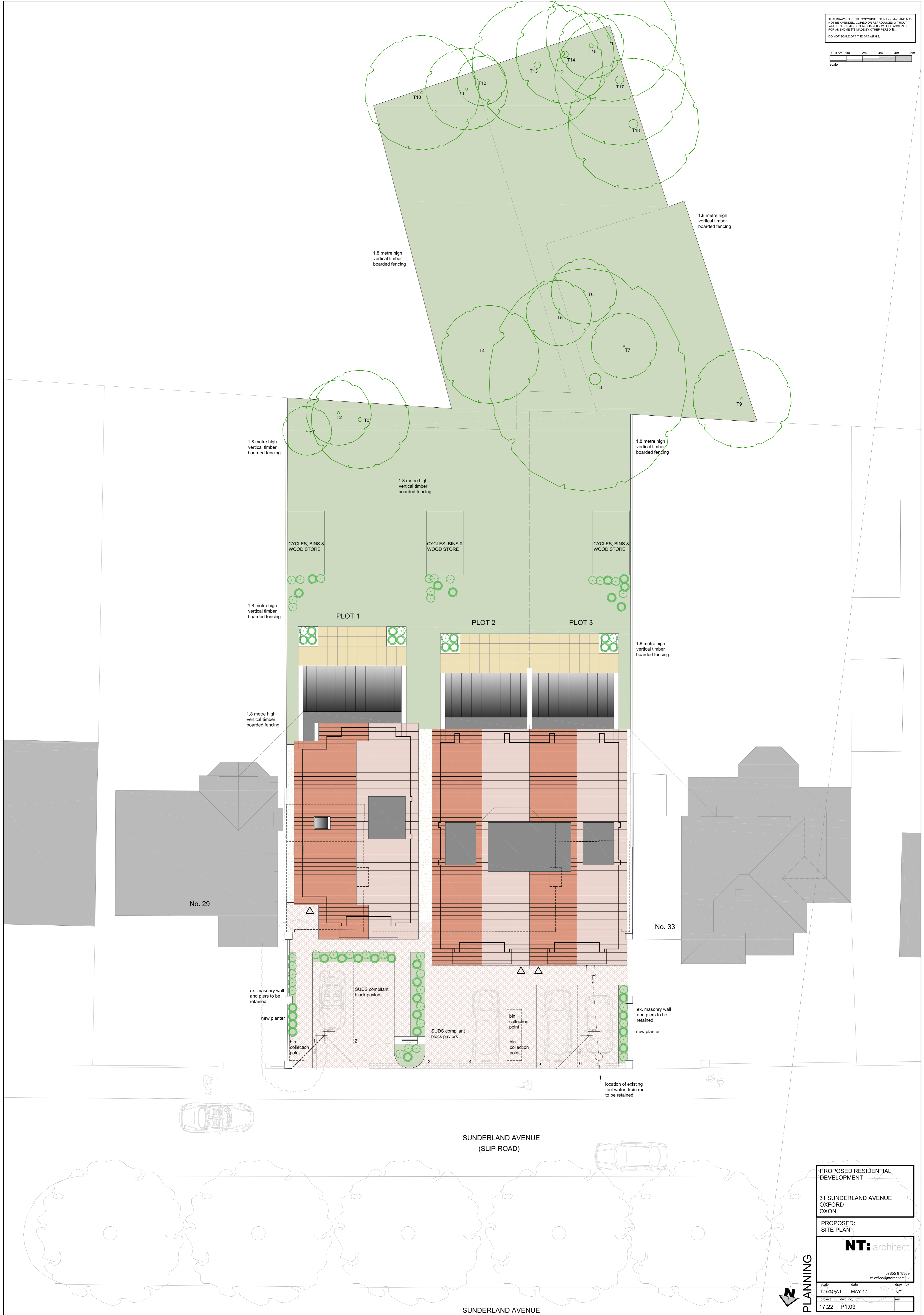
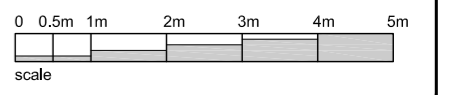

PROPOSED RESIDENTIAL DEVELOPMENT

31 SUNDERLAND AVENUE
OXFORD
OXON.

PROPOSED:
SITE PLAN

NT: architect

T: 07855 978389
E: office@ntarchitect.co.uk

scale	date	drawn by
1:100@A1	MAY 17	NT
project	dwg. no.	rev.
17.22	P1.03	

PLANNING